



Where am I going to live?  
Accommodation guide 2010

# Contents

Welcome	3
City life: Southampton	4
Winchester	5
Why live in halls?	6
Our guarantee to you	7
Our diverse community	8
Part-catered or self-catered?	10
<b>Hall Sites</b>	<b>12</b>
– Wessex Lane	14
– Glen Eyre	15
– Small Halls	16
– Winchester, Portsmouth and Basingstoke	17
<b>Room Types</b>	<b>18</b>
– Standard Room	19
– Enhanced Room	20
– Premium Room	21
– Ensuite Room	22
– Studio Flat	23
– Private Rented	24
How to apply	25
How we allocate	26
Important things to bear in mind	28
Halls fees table	29
Getting here	30
Useful contacts	31

A fantastic experience at university will always be influenced by where you live, as well as your degree course. In Southampton, our halls of residence will enable you to make the most of your time here.

**We provide a range of excellent, high-quality accommodation in a safe, secure and professionally managed environment. Our accommodation package includes internet access and telephony in all single rooms, and a Uni-link bus pass for all residents.**

The halls experience is an essential part of many students' university career – it enables you to meet a diverse range of people from different backgrounds and cultures, on a variety of courses, and you can make friends straight away. Halls offer a varied and vibrant social scene and a range of amenities that include sports facilities, restaurants, shops, launderettes and music rooms across the sites.

Attending university is a major part of anyone's life, and you may have lots of questions. We hope this guide gives you a feel for the halls; however, please do visit our website at [www.southampton.ac.uk/accommodation](http://www.southampton.ac.uk/accommodation) for in depth details, and the most up-to-date information on our halls.

If you have any specific questions about our halls of residence, private accommodation in Southampton, or anything else, please contact us by telephone, email, post, fax or in person (see page 31 for details).

We look forward to meeting you soon!

# Southampton

Southampton is one of the UK's up and coming cities, with superb leisure and cultural facilities. Situated on the south coast, and surrounded by the beautiful New Forest, Southampton has large green areas and a friendly, cosmopolitan feel.

The city offers galleries, cinemas, theatres, restaurants and nightclubs. West Quay Shopping Centre and Retail Park, one of the UK's top 10 shopping destinations, contains all your high street stores in one easy location. The Ocean Village and LeisureWorld complexes provide mainstream entertainment with cinemas, cafes, bars and restaurants, while the Harbour Lights Theatre shows arthouse and cult movies. There is also a wide range of venues that provide evening entertainment for everyone.

Southampton also has much to offer for sporting enthusiasts. The city is one of the UK's premier venues for sailing and watersports, and is also home to both Hampshire County Cricket Club and Southampton Football Club. The Quays Eddie Read Swimming and Diving Complex is the perfect place to take the plunge, and there are many other opportunities both across the city and through the University to partake in sporting and recreational activities.

Conveniently located, Southampton is just over an hour from Central London, and even closer to the coastal resorts of Brighton, Poole and Bournemouth. The Isle of Wight can be seen across the water on a clear day, and the historic cities of Winchester and Salisbury are also nearby. The city enjoys excellent transport links within the UK and to Europe, by road, rail, sea and air, from the city's International Airport.



City nightlife

Gateway to the world



Windsurfing on the Solent

# Winchester

Home to Winchester School of Art, the beautiful and historic city of Winchester is a lively, bustling place with a mixture of the old and the new.

The medieval cathedral provides a fantastic backdrop to the main high street, which is packed with independent shops and household names. There are many cafes, restaurants and pubs to frequent, as well as leisure and sporting facilities to burn off those calories. These include a cinema, museums, swimming pool and gym, playing fields and numerous points of artistic and historic interest.



Winchester's Medieval Cathedral

# Why live in halls?

University is not simply about education, and the halls experience is one we would very much recommend. There are many advantages to living in halls; here are just some of them:

- The student experience: Halls give you the opportunity to mix with people from diverse social and cultural backgrounds, and to enhance social skills and widen your intellectual horizon, all within friendly and welcoming surroundings.
- Our halls are within easy reach of all teaching sites on foot, by bike or on the Uni-link bus service. Uni-link also provide regular services to the city centre, airport, railway and coach stations. As a resident, you will receive a bus pass for the duration of your contract, so the service can be used as often as you like, at no extra cost to yourself!
- All halls offer a safe and secure environment with 24 hour security on all sites and multi-lock access systems.
- No bills! Fees for single rooms in halls include utility bills\*, internet connection and a Uni-link bus pass for the duration of your stay.

- A wide and varied social scene. Hall activities can include live bands, club nights, sporting events including intramural hall tournaments, parties, and in some halls, a Summer Ball.
- The Wardenal Team in halls comprises of staff or students with experience of university life, who can point residents in the right direction for any help they may need. They facilitate communal living by ensuring that students abide by hall regulations in a social, study-conducive environment, and do not breach health and safety rules in their accommodation. A rota system provides out of hours cover. They are not trained to deal with emergency situations, and will contact the appropriate services in such circumstances.

\*A small number of halls require 'top-up electricity', available from the relevant Hall Reception. The fees for affected rooms are lower than comparable rooms with this facility.

You will need to arrange your own belongings insurance and Television Licence; however please note that we cannot guarantee television reception in all halls, so we would advise you to wait until you arrive before investing in a licence.



# Our guarantee to you

**With over 25 halls of residence, top class facilities and a guarantee of an offer of accommodation in your first year, it's no wonder our accommodation is so popular.**

If you are a registered full time first year undergraduate or international postgraduate student, you will be guaranteed an offer of halls accommodation if:

- You submit an application for accommodation by the 1st August in the year in which your studies commence.
- You are unaccompanied and apply for single accommodation (i.e. you do not bring any dependents, such as a partner or child).
- You normally live outside the Southampton City boundary.
- You make the University of Southampton your firm choice (for undergraduate students).

## International students

If you are an international (fee paying) student, you are guaranteed an offer of accommodation in each of your years of study, as long as you apply by the relevant deadline. For your first year this would be the 1st August in the year in which your study commences; for subsequent years the deadline is before the start of the second term. Exact deadlines are published nearer the time – please visit our website at [www.southampton.ac.uk/accommodation](http://www.southampton.ac.uk/accommodation) for further details.

## Insurance students – undergraduates only

If you are an undergraduate student and have made the University of Southampton your insurance choice, you will be offered accommodation in a twin share room for the start of term, as long as you meet the other terms of guarantee stated above. You will then be offered a single room as soon as one becomes available; typically this would be within the first six weeks of term.

## Clearing students – undergraduates only

If you join us through Clearing, we unfortunately cannot guarantee you an offer of halls accommodation. Depending on availability, we may be able to make you an offer on a first-come first-served basis. Please contact us to discuss your options, and also for advice on renting accommodation within the private sector.

## Postgraduate students

- **International:** If you are an International fee paying postgraduate student, you are guaranteed accommodation for your first year as long as you comply with the criteria stated above.
- **UK and EU:** If you are a UK or EU postgraduate student, we are unfortunately unable to guarantee you accommodation. You can apply online, and we may be able to make you an offer of accommodation; however this is dependent on room availability. If we are unable to offer you accommodation, we can provide assistance with renting accommodation in the private sector.

## Meeting our guarantee

In years of exceptional demand, some 'firm choice' students may be offered accommodation in a 'twin-share' room as well as those 'insurance choice' students. This would be on a short term basis, and transfers to single rooms for these affected students are our priority in the first six weeks of term. In addition to this, some students may be offered accommodation in halls that are owned and/or managed by a private company.

# Our diverse community

As our student population continues to broaden and diversify, we continue to improve our service and facilities to meet the widest possible range of individual needs and requirements.

## International students

The University of Southampton has a friendly, diverse community with more than 3,500 students from over 130 countries. We guarantee accommodation to all international fee-paying students for the duration of their studies\*. In halls, you will meet a wide range of people from different cultures, religions and backgrounds, and this will help you become part of this vibrant community. We recognise that our international students may have different needs, and we ask that you inform us of any issues prior to arrival so these can be taken into account.

To help you settle into life in Southampton we offer a range of support services, including:

- A free ‘meet and greet’ service for International students at London Heathrow Airport before the start of the academic year.
- An International Students Welcome Programme, during the week preceding the start of the academic year.
- The Student Visa Guidance Team with experienced professionals offering information on visas and immigration.
- International student academic advisors.

- High speed internet connection in all single rooms in halls, to enable you to keep in touch with friends and family at home.

For more information, please contact our International Office at [international@soton.ac.uk](mailto:international@soton.ac.uk) or visit [www.southampton.ac.uk/international](http://www.southampton.ac.uk/international)

## Postgraduate and mature undergraduate students

We have a range of accommodation suitable for postgraduate and mature undergraduate students, with all types of room available.

We do understand that your lifestyle and work requirements may differ from that of new undergraduate students and we will allocate you in separate areas of halls wherever possible. We also have a limited number of properties suitable for couples and/or families.

We advise students with partners and/or a young child to apply as early as possible as we cannot guarantee this type of accommodation. If suitable accommodation is not available, we can also provide advice and guidance on private rented accommodation in Southampton and Winchester.

\*To fulfil this guarantee, international students will need to apply by the relevant deadline for their second and third years, which is significantly earlier than the deadline for the first year's accommodation. Please see our website at [www.southampton.ac.uk/accommodation](http://www.southampton.ac.uk/accommodation) for further details.



Students socialising

We also administer the SASSH scheme, a private rented accreditation scheme in conjunction with the Southampton City Council and Southampton Solent University. We can even put you in touch with fellow students looking to share a house. Please contact us for more details, and for in-depth discussions on your options.

## Students with disabilities or health conditions

We offer a range of specially adapted accommodation for students with disabilities or health conditions and work closely with the University's Disability and Mentor Service to enhance and extend facilities.

If you have a disability or health condition, and would like to discuss your requirements, please contact the Accommodation Service before you apply. You should also contact the Disability and Mentor Service as early as possible to discuss your academic and other support needs, and also to arrange a visit.

Telephone: +44 (0)23 8059 7726  
Email: [enable@soton.ac.uk](mailto:enable@soton.ac.uk)

The Uni-link bus service connects all hall and teaching sites as well as the city centre, airport, train and coach stations and all buses have low floors to allow access to those with disabilities.

# Part-catered or self-catered?

## Part-catered

In part-catered accommodation, residents have breakfast and a main meal on weekdays (either at lunch or in the evening), with brunch on Saturdays and lunch on Sundays. You can even take your meal on one of our teaching campuses. Residents of part-catered accommodation enjoy a wide choice of delicious, freshly prepared dishes, ranging from pastas to roasts, and from pizzas to sandwiches. Salads and potatoes are always an option, and a vegetarian dish is included on all menus. Halal and Kosher food is also available and most dietary requirements can be catered for by prior arrangement. You will also receive the flexibility of part-catering during term times and self-catering during holidays.

You can find more details about part-catering on the Catering Service website at [www.southampton.ac.uk/catering](http://www.southampton.ac.uk/catering).

## Self-catered

In self-catered accommodation, we provide the kitchen facilities and you provide the culinary skills! All students have access to a shared kitchen, with cooking equipment and lockable storage – all you will need to bring is cutlery, plates, cups, glasses and saucepans (and food!). Self-catering is best if you like to live more independently or if you have special dietary needs. Shopping for food couldn't be easier; all our halls are within easy reach of shops and supermarkets, either on foot or via the *Uni-link* bus service. There is also a large Farmers' Market on the Highfield Campus every Monday during term time, and the Students' Union shop stocks a variety of chilled and frozen foods. If you are on the Glen Eyre or Wessex Lane Complexes, you can also dine in the on-site restaurants on a 'pay-as-you-eat' basis.

## Contract length

We offer three types of contract length, detailed in the table below. Undergraduates can only apply for short and standard length contracts online; if you require a longer contract, please contact us to discuss this. Contracts commence on the weekend preceding Fresher's Week, and the short and standard contracts end on the 1st July.

Contract Name	Duration	Period
Short Contract*	34 weeks	September - March, April - July
Standard Contract	39 weeks	September - July
Long Contract	51 weeks	September - September

Occasionally, undergraduate courses run beyond 1st July. In these cases, you will not need to extend your standard contract to a long contract; rather, you can apply for 'Out of Term Residence' at your Hall Reception once you are in residence. Please note that some halls do not offer all types of contract, and specific contract dates may vary.

For full details please check the Accommodation Service website at [www.southampton.ac.uk/accommodation/apply/fees](http://www.southampton.ac.uk/accommodation/apply/fees)

\*Residents on a short contract will need to vacate their room over the Easter vacation period and remove all their belongings. There are no storage facilities at the halls for this period.



Self-catered students

# Hall Sites

**In Southampton, we have three Hall Complexes – Wessex Lane, Glen Eyre and the Small Halls.**

Each have their own style and character, and all feature the facilities you would expect, such as launderettes, communal space and Junior Common Rooms. All are within easy reach of a Uni-link bus service.

Each hall has specific room types and catering options that are available to residents. The table below outlines what is available in each hall, and the student type that is generally allocated to each of our premises. However, please be aware that the table is for guidance only, as it may be necessary to amend the types of students allocated to each hall depending on prospective student interest and room availability.

	Number of Rooms	Undergraduates	Postgraduates	Self-Catered	Part-Catered	Standard Room	Enhanced Room	Premium Room	Ensuite Room	Self-Contained Flat
Montefiore 1	293	✓	✗	✓	✗	✓	✗	✗	✗	✗
Montefiore 2	416	✓	✓	✓	✗	✗	✓	✗	✗	✗
Montefiore 3	595	✓	✓	✓	✗	✗	✗	✗	✓	✗
Montefiore 4	158	✓	✓	✓	✗	✗	✗	✗	✓	✗
Connaught Hall	289	✓	✗	✗	✓	✓	✓	✗	✗	✗
Chamberlain Hall	167	✓	✗	✗	✓	✓	✗	✗	✓	✗
Chancellors' Courts	605	✓	✓	✓	✗	✗	✗	✓	✓	✓
Glen Eyre Self-Catered*	431	✓	✓	✓	✗	✓	✓	✗	✗	✗
J Block	97	✓	✓	✗	✓	✓	✗	✗	✗	✗
Hartley Grove	400	✓	✗	✓	✗	✗	✗	✗	✓	✗
South Hill	190	✓	✓	✓	✓	✗	✗	✗	✓	✗
New Terrace	180	✓	✓	✓	✗	✗	✗	✗	✓	✗
Bencraft Court	228	✓	✓	✓	✗	✓	✗	✗	✗	✓
Highfield Hall	229	✓	✓	✗	✓	✓	✓	✗	✓	✓
Gateley and Romero	414	✓	✗	✓	✗	✗	✗	✗	✓	✗
Shaftesbury Avenue	10	✓	✓	✓	✗	✗	✗	✗	✗	✓
Gower Building	22	✗	✓	✓	✗	✗	✗	✗	✗	✓
St Margaret's House	96	✗	✓	✓	✗	✗	✓	✗	✗	✓
Erasmus Park	378	✓	✓	✓	✗	✗	✗	✗	✓	✗

\*Please note that Glen Eyre Self-Catered includes the following halls: Beechmount House, Brunei House, Main building, Old Terrace and Richard Newitt Courts.



Students on their way to lectures

# Wessex Lane

Situated a 10 minute bus ride from the main Highfield Campus, Wessex Lane Halls comprise of Montefiore 1, 2, 3 and 4, and Connaught Hall. Wessex Lane has the feel of a traditional student village, and houses around 1,800 residents.

The complex features all room types, and is suitable for both undergraduate and postgraduate students. It has a vibrant social scene, 24 hour reception and landscaped gardens open to all residents. It is also very well served by the Uni-link bus service, with buses calling 6 times an hour during peak times.

## Features include:

- Internet connection and telephony in all rooms
- Launderette
- Gym
- Music room
- The 'Galley' restaurant serving hot and cold meals (including a takeaway service)
- Snooker room
- Secure bicycle storage
- 24 hour reception
- TV room and computer room
- A wide range of social events
- Barbeque areas
- Tennis courts and a large landscaped garden
- Regular Uni-link bus service (U1 and U6)

# Glen Eyre

Our Glen Eyre Hall Complex is around a 5 minute bus ride from the main Highfield Campus, and features a number of blocks, including Hartley Grove, Brunei House and Chancellors' Courts.

Situated in attractive landscaped surroundings, it is home to around 2,000 undergraduate and postgraduate students. Most room types are available, with both standard and long-let, and part-catered and self-catered contracts. Glen Eyre has a 24 hour reception, a Junior Common Room-run shop, and barbeques on the lawn for those long summer afternoons.

## Features include:

- Internet connection and telephony in all rooms
- Launderette
- Fitness suite and squash court
- TV room and computer room
- Music room
- Secure bicycle storage
- 24 hour reception
- Barbeque areas
- The 'Chambers' restaurant, serving hot and cold meals (including a takeaway service)
- A wide range of social events
- Regular Uni-link bus service (U2, and U1, U6 and U9 from the Highfield Interchange, a 10 minute walk from Glen Eyre complex)



Wessex Lane Complex



Glen Eyre Complex

# Small Halls

In Southampton, we have a number of halls based around the city, not on centralised hall complexes. These are referred to as the Small Halls, and can house around 1,000 students across the halls within a range of room types, with both self-catered and part-catered contracts available.

Gateley, Romero and St Margaret's House are close to the City Centre and the student-friendly Bedford Place, while Bencraft Court and Highfield Hall are set in quieter, greener areas of Southampton. Shaftesbury Avenue Apartments and the Gower Building offer accommodation suitable for postgraduates and students with partners and/or a young child. All of the Small Halls feature comparable facilities to those on the two large hall complexes, but have their own style and character, and a close-knit community feel.

## Features include:\*

- Internet connection and telephony in all rooms
- TV rooms and computer rooms
- Communal areas and pool tables
- Secure bicycle storage
- A wide range of social events
- Launderettes
- Local parks and common land
- Regular Uni-link bus service (U1, U2 and U9, dependent on the specific hall)

\*Facilities vary across the Small Halls – please check our website at [www.southampton.ac.uk/accommodation](http://www.southampton.ac.uk/accommodation) for specific details.



Small Halls

# Winchester, Portsmouth and Basingstoke

## Erasmus Park

For our students studying in Winchester we offer accommodation within Erasmus Park. We have 378 rooms with ensuite facilities, all fitted with internet connection and telephony. Erasmus Park is managed by the Small Halls management team, who are based in Gateley Hall, Southampton.

Each flat has a shared kitchen for food preparation, as Erasmus Park is entirely self-catered. As with our halls in Southampton, Erasmus Park has communal areas, a launderette, TV room and bicycle storage facilities. In 2009/10, an ensuite room cost £103.95.

## Balmoral House and Victoria Place – Portsmouth, and North Hampshire Hospital Accommodation – Basingstoke

These halls of residence are based in Portsmouth and Basingstoke, and are therefore only suitable for nursing students based in these cities. Facilities and room types can vary, and the halls are owned and managed by the NHS or private providers, so please check our website at [www.southampton.ac.uk/accommodation](http://www.southampton.ac.uk/accommodation) for specific details.



Erasmus Park, Winchester

# Room Types



We have a range of room styles within our Halls of Residence, from standard rooms through enhanced, and premium, to rooms with private ensuite facilities.

Each room in halls features a bed, a desk, a chair, a wardrobe, storage space and a noticeboard. All rooms have telephony and high speed internet access, and all residents have access to shared kitchens. If your room does not have an ensuite toilet and shower, you will also have access to shared bathroom facilities.

Some rooms have personal washbasins, and all rooms include membership of the Junior Common Room, and a Uni-link bus pass in their rent. We also have a limited number of self contained flats, generally suitable for postgraduate students, and students with partners and/or a young child.

# Standard Room



A study bedroom where residents share kitchen and bathroom facilities with between eight and twenty residents. Some standard rooms include a personal or shared washbasin. Standard rooms are available across all hall sites, with both part-catered and self-catered options.

In 2009/10, the cost of a self-catered standard room was between £71.40 and £89.25, and the cost of a part-catered standard room was between £103.95 and £121.45.

Please note that the floor plans and photos are for general guidance only, and the actual layouts may vary from room to room and from hall to hall.

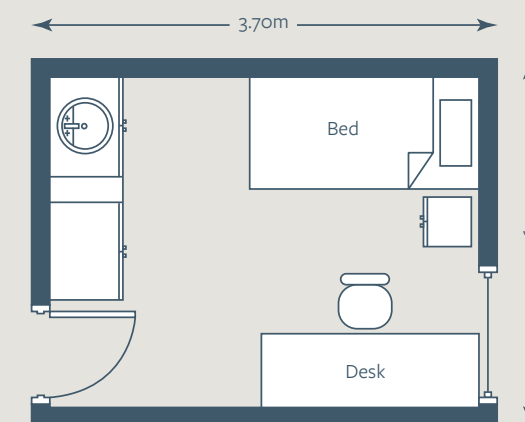

# Enhanced Room



A study bedroom where residents share kitchen and bathroom facilities with no more than seven other residents. Most enhanced rooms contain a personal washbasin. Enhanced rooms are available across all sites, with part-catered and self-catered contracts on different hall complexes.

In 2009/10, a self-catered enhanced room cost between £86.45 and £97.30 per week, and a part-catered enhanced room cost £128.80 per week.

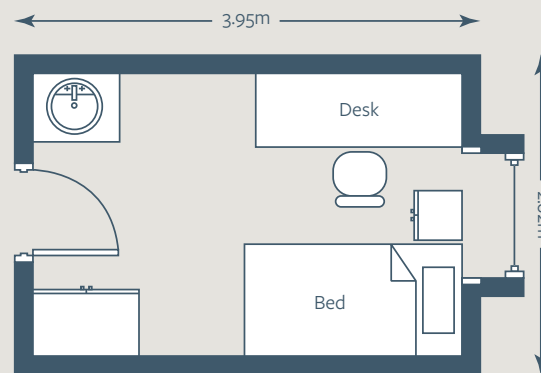

Please note that the floor plans and photos are for general guidance only, and the actual layouts may vary from room to room and from hall to hall.

# Premium Room



A study bedroom where residents share kitchen and bathroom facilities with no more than seven other residents. Premium rooms also feature a queen sized bed (larger than a standard single bed) and are only available on the Glen Eyre complex, on a self-catering basis.

In 2009/10, a self-catered premium room cost £103.60 per week.

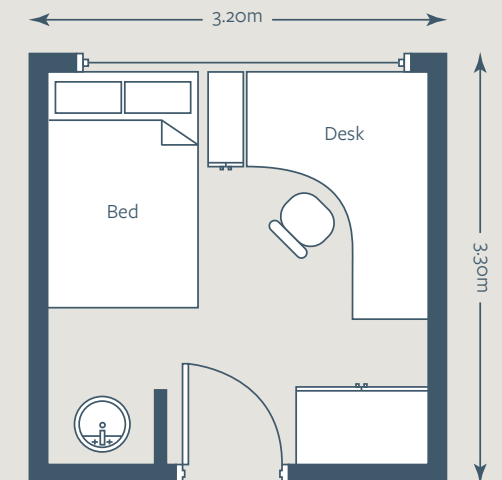

Please note that the floor plans and photos are for general guidance only, and the actual layouts may vary from room to room and from hall to hall.

# Ensuite Room



A study bedroom where, in general, residents share kitchen facilities with no more than seven other residents. These rooms have their own personal ensuite bathroom facilities, fitted with shower, washbasin and toilet. Ensuite rooms are available across all hall sites, with both part-catered and self-catered contracts available on different sites.

In 2009/10, a self-catered ensuite room cost between £101.85 and £114.80 per week, while a part-catered ensuite room cost between £146.30 and £152.95 per week. Please note that this is the only room type available in Erasmus Park, Winchester, and that there are also Premium Ensuite rooms available on the Wessex Lane complex, which combine the features of a premium room and an ensuite room.

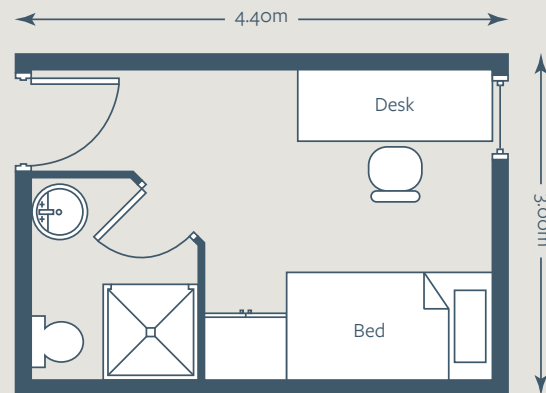

Please note that the floor plans and photos are for general guidance only, and the actual layouts may vary from room to room and from hall to hall.

# Studio Flat



Studio flats and one bedroom apartments are available on the Glen Eyre and Small Halls complexes. Fitted with a bed, a desk, a chair, a wardrobe and storage space, self contained flats are generally only suitable for postgraduates and mature students, or students with a partner or young child. Competitively priced, all flats feature a bathroom with shower, washbasin and toilet, and also have a fitted kitchen area with all white goods provided. We have a very limited supply of these flats, and cannot guarantee an offer of this form of accommodation to all applicants. Most flats come with internet access and telephony, while Junior Common Room membership and a Uni-link bus pass are also included.\*

\*Please note the Uni-link bus pass is not available in Shaftesbury Avenue Apartments. Please also note that one pass is issued per flat in all other halls, so will only be available for one resident in couples accommodation.

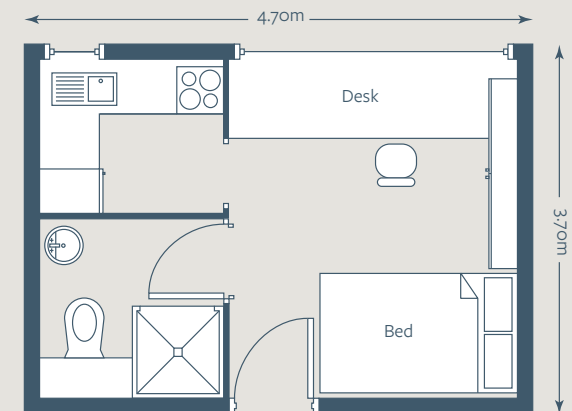

Please note that the floor plans and photos are for general guidance only, and the actual layouts may vary from room to room and from hall to hall.

# Private Rented



Typical private rented accommodation in Southampton

Southampton has a wide range of private rented accommodation, mostly within a short travelling distance of the main teaching sites. This gives students a wide choice of location and property type. Rent typically costs around £65 per week, excluding bills.

When you choose this type of accommodation, you enter into a contract directly with the landlord. You should therefore ensure you fully understand the terms and conditions before signing the contract, as it is a legally binding agreement.

We, at the Accommodation Service, will be happy to check any contract for you before you sign it, and answer any questions you may have.

We are a core partner in the Southampton Accreditation Scheme for Student Housing (SASSH) programme in conjunction with Southampton City Council and Southampton Solent University. SASSH only advertises properties that conform to a set of safety standards (details available on our website) and this accommodation may be subject to inspections by Southampton City Council.



Enjoying life in halls

## How to apply

You should apply for accommodation as soon as you have your formal offer of study at the University of Southampton. The offer letter/email will include your all-important eight digit student identification (ID) number. If you can't locate your ID number, please contact your Academic School directly, or the Accommodation Service on +44 (0)23 8059 5959.

Once you have your student ID number, you can apply for your accommodation online at [www.onlineaccommodation.soton.ac.uk](http://www.onlineaccommodation.soton.ac.uk). You will first need to register your details, and then continue to complete and submit an application form. You will be asked to tell us:

- Whether you would prefer self-catered or part-catered accommodation.
- Your preferred room type.
- Your contract length.
- Your preferred Hall location.
- If you have any special requirements (ie medical/dietary/cultural requirements).

Once you have submitted your preferences on your application form, you can check the status of

your application via your University of Southampton Accommodation Account at [www.onlineaccommodation.soton.ac.uk](http://www.onlineaccommodation.soton.ac.uk).

If you have applied in line with our accommodation guarantee, you will be made an offer of accommodation once you have met your conditions of study. Most students, including those prospective undergraduates waiting for A level results, will be notified between mid-August and mid-September. Students may receive an offer earlier if they have already met their conditions of study (for example those students who have deferred entry from a previous year) and we will commence making offers of accommodation to students from the middle of May.

### Things to Consider

When applying for accommodation, please take the following things into consideration:

- **Cost:** most contracts run for 40 weeks, so please look at your student finance package and any additional support you may receive (from parents, savings, summer jobs etc).

- **Location:** While some halls may be closer to your teaching site than others, the Uni-link bus service offers regular and reliable transport all around Southampton, and you will receive a bus pass for the duration of your contract, as part of your accommodation package.

You will have the opportunity to make friends for life wherever you live, so please do not be disheartened if you do not receive your first choice of accommodation. As such, we would advise you to spread your preferences over a number of hall sites and room types.

# How we allocate

When allocating accommodation, we use the information you have provided on your application form to select the most appropriate room. We aim to match every student's preferences and profile details; however, when this is not possible, the next best alternative will be offered.

## Things we take into account

- **Medical issues** – We want you to be as happy as possible while you're staying with us so we will always try to take into account your medical situation. However, please advise us of any special considerations as early as possible so we can take these into account when allocating you a room. Please contact the Accommodation Service to discuss these issues in more detail. Please also note that we require supporting documentation alongside your accommodation application.
- **Cultural issues** – Please advise us of any cultural issues we may need to consider during room allocation.
- **Year of study/degree level** – We aim to group together students at a similar point in their studies since first year undergraduates may, for example, have different lifestyles from postgraduates.
- **Availability of rooms** – We have a wide range of rooms; however some types of accommodation are more popular than others and we cannot guarantee an offer of a particular type or location.

## Things we don't take into account

- **Date of application** – You are guaranteed an offer of accommodation provided that you have applied by the 1st August deadline. We do not make offers on a first-come first-served basis, and you will not receive an offer of accommodation until you have met your conditions of study.
- **Teaching campus** – We strongly believe that students should have the chance to mix with a variety of members of the university, and as such we do not take your course or teaching site into consideration when allocating a room.\*
- **Academic achievement** – We do not take into account your academic history during room allocation.

\*If you are based on a teaching campus outside of Southampton, this will be taken into account during the allocation process.



# Important things to bear in mind

- We will take your stated preferences into account; but we cannot guarantee meeting any specific preference to any student, as room allocation is entirely dependent on availability at the time of allocation. You will be offered the most suitable room available on the day you are allocated. In 2008/09, 89% of applicants received one of their three preferences, with 65% receiving their first preference. However there will be applicants whose preferences we cannot match; in instances such as this we will allocate you the most suitable room available at the time, and you can then apply to transfer to alternative university accommodation once you have arrived in Southampton.

- You will be notified of your offer by email; however we would advise that you also regularly check your Accommodation Account to ensure you do not miss the offer.

- If you are likely to be away please ensure you check your emails and online Accommodation Account regularly (or arrange for someone to do this on your behalf) to ensure you do not miss the offer of accommodation.

- We will not make you an offer of accommodation until you have met your conditions of study. For those who have already met their conditions (for example students who hold a deferred place at the University) we will start making offers of accommodation from the middle of May.

- Your offer of accommodation is only valid for a limited period – its expiry date will be displayed when you view the offer. If you do not respond, as instructed in the offer, by the due date, it will be withdrawn and the room will be offered to another student. If this occurs and you still require university accommodation

you may request reconsideration of your application, but you should be aware that a second offer is not guaranteed.

- Please make sure you advise us of any special requirements – if you don't let us know, we cannot help! Please include details on your application form, or contact us if you require specialist advice.

- You should be aware that in making its initial offer of accommodation to you, the University of Southampton has met its guarantee to you. It is YOUR RESPONSIBILITY on receipt of your offer to respond accordingly. The University of Southampton and the Accommodation Service cannot accept responsibility should you miss, or fail to respond to, your offer of accommodation. We will offer advice and support in looking for private rented accommodation should you need it.

# Costs

## Wessex Lane - Fees 2009/10

Room type	No. of rooms	Weekly price	Type of student
Standard room (Self-catered)	293	£71.40 - £75.95	Undergraduates and Postgraduates
Enhanced room (Self-catered)	416	£86.45	Undergraduates and Postgraduates
Ensuite room (Self-catered)	700	£101.85 - £103.95	Undergraduates and Postgraduates
Premium Ensuite room (Self-catered)	53	£107.45	Postgraduates
Standard room (Part-catered)	213	£103.95 - £116.55	Undergraduates

## Glen Eyre - Fees 2009/10

Room type	No. of rooms	Weekly price	Type of student
Standard room (Self-catered)	283	£89.25	Undergraduates and Postgraduates
Enhanced room (Self-catered)	146	£97.30	Undergraduates and Postgraduates
Premium room (Self-catered)	314	£103.60	Undergraduates and Postgraduates
Ensuite room (Self-catered)	890	£112.35 - £114.80	Undergraduates and Postgraduates
Flat (Self-catered)	99	£140.35	Postgraduates
Standard room (Part-catered)	263	£108.85 - £121.45	Undergraduates
Ensuite room (Part-catered)	75	£147.35 - £152.95	Undergraduates

## Small Halls - Fees 2009/10

Room type	No. of rooms	Weekly price	Type of student
Standard room (Self-catered)	213	£75.95	Undergraduates and Postgraduates
Enhanced room (Self-catered)	84	£86.45	Undergraduates and Postgraduates
Ensuite room (Self-catered)	414	£103.95	Undergraduates
Flat (Self-catered)	75	£112.35 - £166.95	Undergraduates and Postgraduates
Standard room (Part-catered)	115	£120.75	Undergraduates
Enhanced room (Part-catered)	55	£128.80	Undergraduates
Ensuite room (Part-catered)	43	£146.30	Undergraduates

## Erasmus Park - Fees 2009/10

Room type	No. of rooms	Weekly price	Type of student
Ensuite room (Self-catered)	378	£103.95	Undergraduates and Postgraduates

New first year undergraduate students do not have to make a prepayment for halls accommodation. New postgraduate students must make a prepayment of £350 at the time of online acceptance; this will then be deducted from the final instalment of your residence fees.

**Payment of Hall Fees:** Payment can be made by Direct Debit or Recurring Card Payment in three instalments (four on a long let contract). The first payment is normally due in October.

**Private Rented Accommodation:** Rent in a shared house in Southampton or Winchester typically costs £60 - £70 per week, excluding bills, such as gas, electricity, water, internet etc.

Please note that the fees stated above are for the academic year 2009/10. Please check [www.southampton.ac.uk/accommodation](http://www.southampton.ac.uk/accommodation) for more up-to-date information.

# Getting here



# Useful contacts

**Accommodation Service**  
George Thomas Building 37  
University of Southampton  
Highfield  
Southampton  
SO17 1BJ

Tel: +44 (0)23 8059 5959  
Fax: +44 (0)23 8059 3959  
Email: accommodation@soton.ac.uk

**University of Southampton  
Main Switchboard**  
Tel: +44 (0)23 8059 5000

**International Office**  
Tel: +44 (0)23 8059 2772  
Email: international@soton.ac.uk

**Student Services Centre**  
Tel: +44 (0)23 8059 9599  
Fax: +44 (0)23 8059 9595  
Email: ssc@soton.ac.uk

**Uni-link Office/Transport Manager**  
Tel: +44 (0)23 8059 5974  
Email: unilink@soton.ac.uk  
Term time Hours: 0930-1600,  
Vacation Hours: 0930-1400

**Financial Information and Assistance**  
Tel: +44 (0)23 8059 3287  
Email: stufunds@soton.ac.uk

**Students' Union Advice and Information  
Centre**  
Tel: +44 (0)23 8059 2085  
Fax: +44 (0)23 8059 5235  
Email: suiac@susu.org

**Disability and Mentor Service**  
Tel: +44 (0)23 8059 7726  
Email: enable@soton.ac.uk

This information can be made available, on request, in alternative formats, such as electronic, large print, Braille or audio tape and, in some cases, other languages.

Please contact us for further information.

## Disclaimer

This brochure is prepared well in advance of the academic year to which it relates, and the University offers the information contained in it as a guide only. While the University makes every effort to check the accuracy of the factual content at the time of drafting, some changes will have inevitably occurred in the interval between publication and the start of the relevant academic year. You should not rely solely on this brochure and you should regularly visit our website or contact the Accommodation Service directly if you would like any further information. Please visit [www.southampton.ac.uk/accommodation](http://www.southampton.ac.uk/accommodation). You should also consult the University's prospectus or visit [www.southampton.ac.uk/inf/termsandconditions.html](http://www.southampton.ac.uk/inf/termsandconditions.html) for more specific details of the limits of the University's liability in the event of changes to advertised courses/programmes/facilities and related information.

© University of Southampton 2009

[www.southampton.ac.uk/accommodation](http://www.southampton.ac.uk/accommodation)  
[accommodation@soton.ac.uk](mailto:accommodation@soton.ac.uk)  
+44 (0)23 8059 5959